

**STANDARD CONSTRUCTION**
**FRAME:**

EXTRUDED ALUMINUM CONSTRUCTION.  
FRAME IS ASSEMBLED USING CORNER CLIPS TO  
ASSURE HAIRLINE MITERED CORNERS.

**ACCESS DOORS:**

MADE OF STUCCO EMBOSSED GALV-ALUM SHEET  
(AZ50) WITH A PERIMETER ALUMINUM CHANNEL  
AND 13/16" LIGHTWEIGHT FOIL FACED FIBERGLASS  
BOARD FOR INSULATION AND SOUND ATTENUATION.

**FINISH:**

SKY-WHITE (STANDARD)

AXALTA SKY-WHITE 100% POLYESTER POWDER  
COATING GIVES AN ATTRACTIVE BRIGHT WHITE  
FINISH AND PROVIDES ADDITIONAL PROTECTION  
FROM AGING AND WEAR.

**SIZES AVAILABLE:**

FROM 38" X 38" MIN  
(1,440 SQ. INCHES)

TO 50" X 50" MAX  
(2,500 SQ. INCHES)

CUSTOM SIZES AVAILABLE UPON REQUEST.

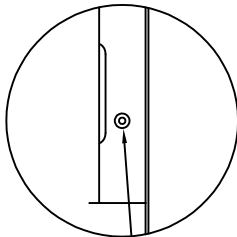
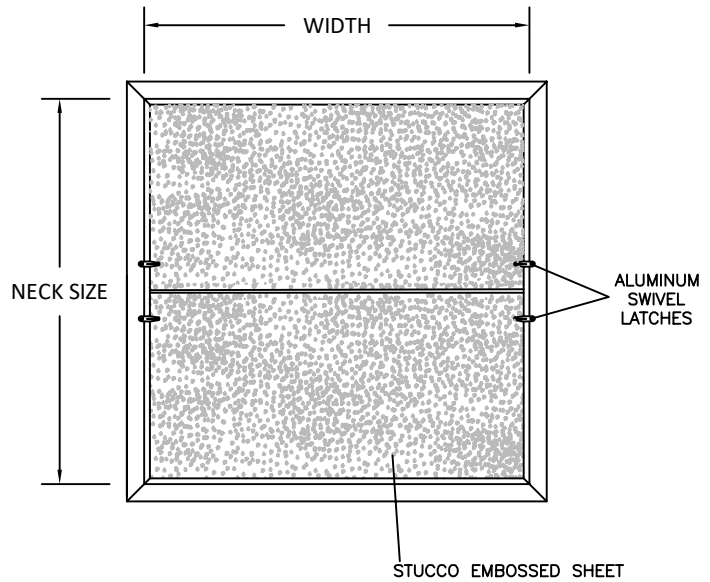

HIDDEN INSTALLATION  
SCREW HOLE (2 PER SIDE)

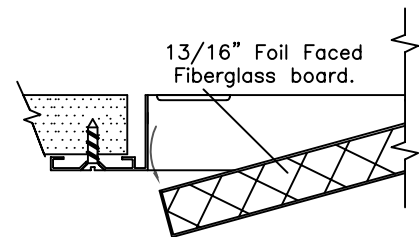
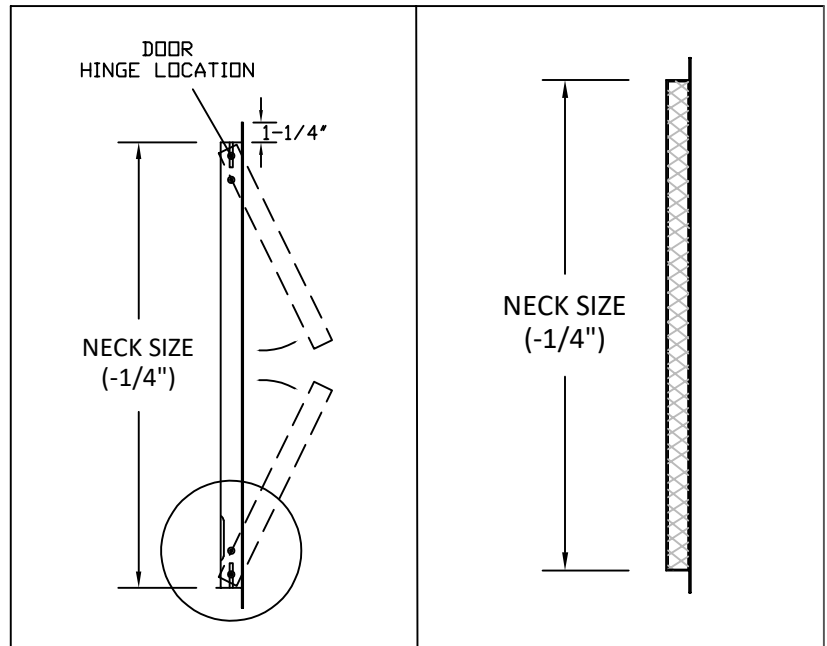

JOB NAME:
LOCATION:
ARCHITECT:
ENGINEER:
CONTRACTOR:
CONTACT GRILLE TECH INC. FOR ADDITIONAL INFORMATION OR WITH SPECIAL REQUIREMENTS.
5101 NW 36TH AVE MIAMI, FL 33142 PHONE: 305-537-0053 FAX: 305-537-0064
WEB: WWW.GRILLETECHINC.COM EMAIL: SALES@GRILLETECHINC.COM

**WAPIDD**

DOUBLE DOOR WALL ACCESS PANEL  
WITH INSULATION

NOTE: ALL DRAWINGS SUBJECT TO CHANGE WITHOUT PRIOR NOTICE.

DRAWN BY: MR	DATE: 6/18/18	SCALE: NOT TO SCALE	DRAWING NO. WAPIDD
CHECKED BY: IG	DATE: 6/18/18	REVISION: 6/18/18	